

Load Cell LC/eLC

6 measuring ranges from 500 N up to 20 kN

Special Features

- Load cell for compression forces
- Ideal for a narrow space due to their slim shape
- Developed for mounting or bonding on presses and similar devices
- IP 64 protected

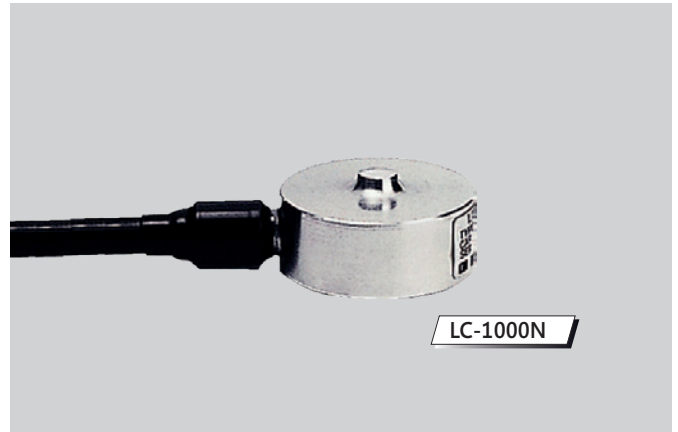

Load Cell for Indicator ZTS/ZTA

Model	Capacity	Resolution	Accuracy*
LC-500N	500 N	0.1 N	± 0.5 % full scale
LC-1000N	1000 N	1 N	
LC-2000N	2000 N	1 N	
LC-5000N	5000 N	1 N	
LC-10kN	10 kN	0.01 kN	
LC-20kN	20 kN	0.01 kN	

*It is the accuracy of the load cell and indicator combined.

Load Cell for Indicator eZT

Model	Capacity	Resolution	Accuracy*
eLC-500N	500 N	0.1 N	± 0.7 % full scale
eLC-1000N	1000 N	1 N	
eLC-2000N	2000 N	1 N	
eLC-5000N	5000 N	1 N	
eLC-10kN	10 kN	0.01 kN	
eLC-20kN	20 kN	0.01 kN	

*It is the accuracy of the load cell and indicator combined.

Dimensional Drawing

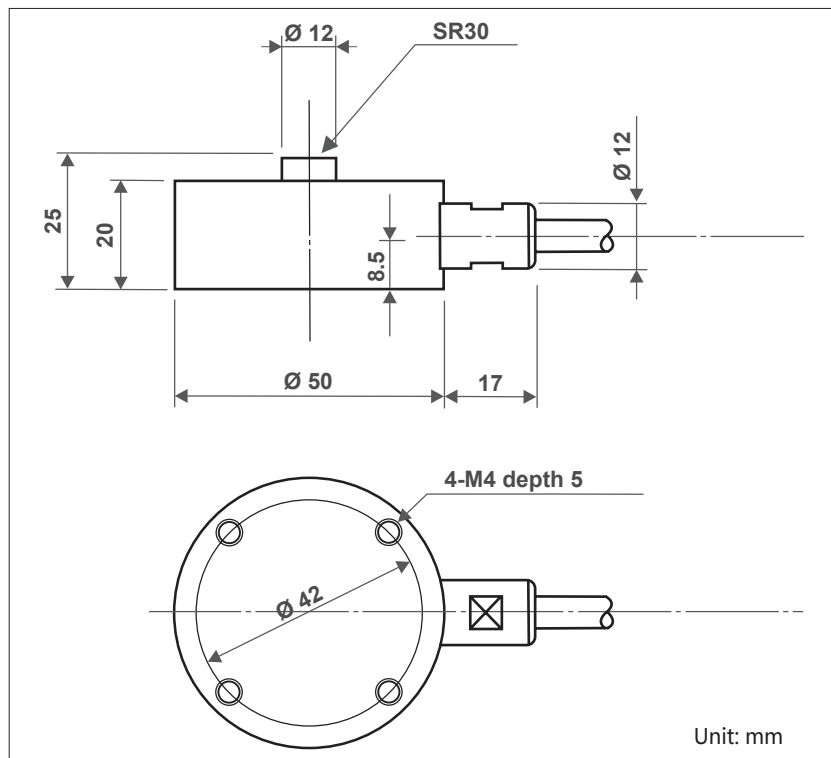

LC-E - Subject to change without notice.

Hans Schmidt & Co GmbH
Schichtstr. 16
84464 Waldkraiburg Germany

Phone: int. + 49 / (0)8638 / 9410-0
Fax: int. + 49 / (0)8638 / 4825

e-mail: info@hans-schmidt.com
Internet: <http://www.hans-schmidt.com>

Specifications	LC	eLC
Accuracy:*	± 0.5 % full scale or less	± 0.7 % full scale or less
Rated output:	2.0 mV/V ± 0.25 %	—
Nonlinearity	0.15 % R. O.	—
Hysteresis:	0.1 % R. O.	—
Recommended voltage:	1 - 10 V AC or DC	—
(Allowed voltage)	15 V AC or DC	—
Overload capacity:	150 %	150 %
Recommended temperature:	-10 - 70 °C	-10 - 70 °C
(Allowable temperature)	-15 - 80 °C	-15 - 80 °C
Temperature influence for 0 degree:	0.005 %/°C	—
Temperature influence for output:	0.01 %/°C	—
Cable:	Approx. 5 m	Approx. 5 m
Weight:	Approx. 500 g	Approx. 500 g
Protection rating:**	IP64	IP64

* It is the accuracy of the load cell and indicator combined.

** Protection rating is only approved for the sensor. The indicator, the connector parts and cable are not secured.