

# Load Cell CHX/eCHX

3 measuring ranges from 100 N up to 2000 N

## Special Features

- Load cell for compression forces
- Small body, ideal for measurements in limited space
- IP 64 protected
- Washer type sensor (through hole), suitable for press-fit force measuring

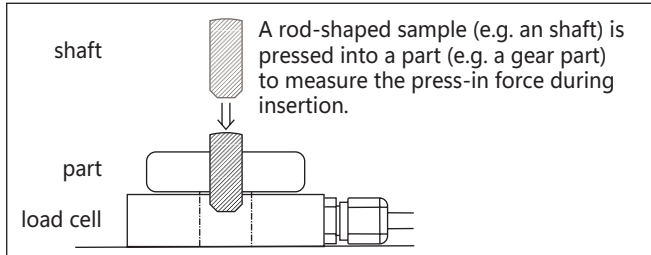

## Load Cell for Indicator ZTS/ZTA

Model	Capacity	Resolution	Accuracy*	Hole Diameter
<b>CHX-100N</b>	100 N	0.1 N	± 2.0 % full scale	6.6 mm
<b>CHX-500N</b>	500 N	0.1 N		
<b>CHX-2000N</b>	2000 N	1 N	± 1.0 % full scale	10.0 mm

\*It is the accuracy of the load cell and indicator combined.

## Load Cell for Indicator eZT

Model	Capacity	Resolution	Accuracy*	Hole Diameter
<b>eCHX-100N</b>	100 N	0.1 N	± 2.2 % full scale	6.6 mm
<b>eCHX-500N</b>	500 N	0.1 N		
<b>eCHX-2000N</b>	2000 N	1 N	± 1.2 % full scale	10.0 mm

\*It is the accuracy of the load cell and indicator combined.

## Dimensional Drawing

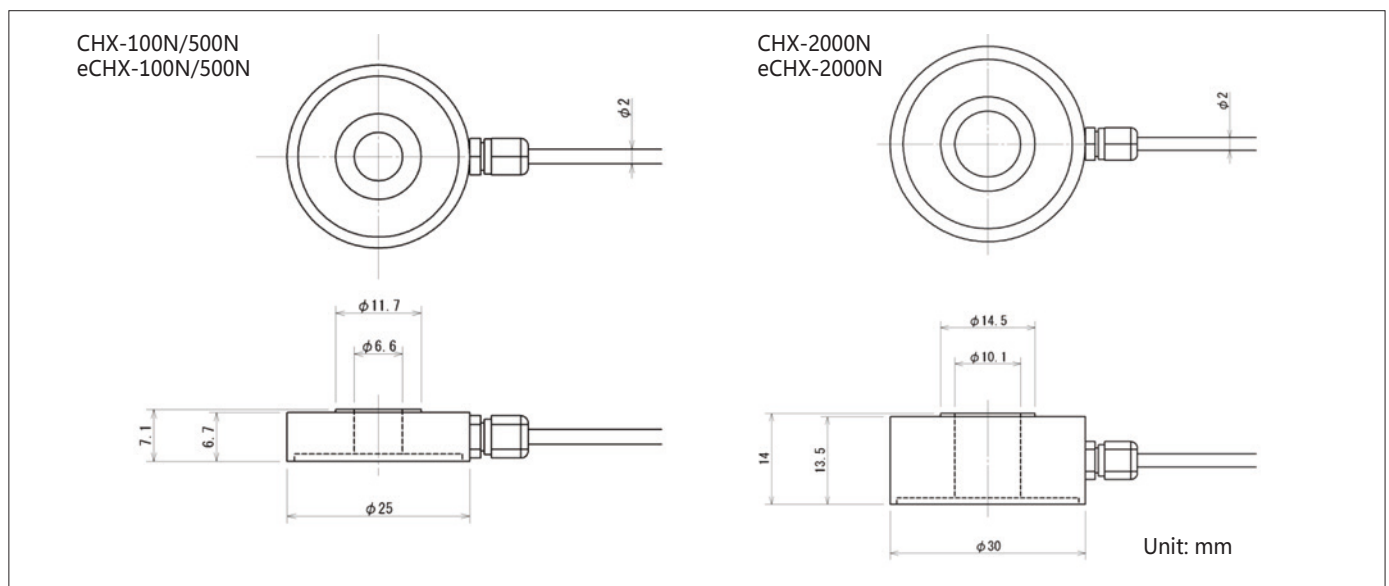

CHX-E - Subject to change without notice.

**Hans Schmidt & Co GmbH**  
Schichtstr. 16  
84464 Waldkraiburg Germany

Phone: int. + 49 / (0)8638 / 9410-0  
Fax: int. + 49 / (0)8638 / 4825

e-mail: info@hans-schmidt.com  
Internet: http://www.hans-schmidt.com

## Operation

- The load cell takes up the force in the area indicated in black.

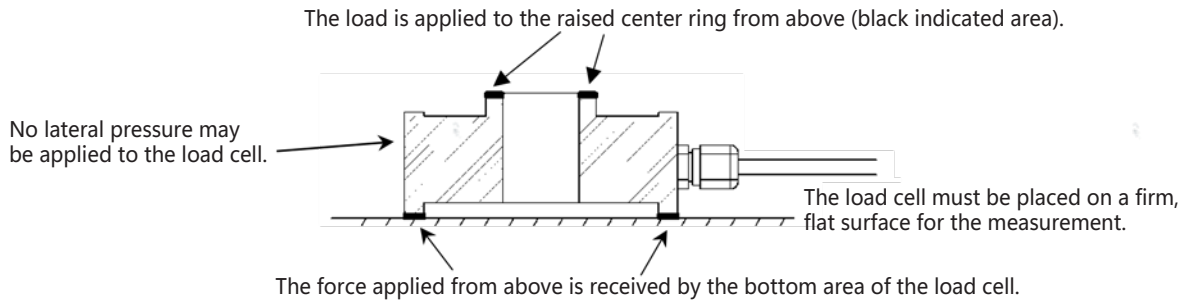

- The load applied from above distorts the load cell during the measurement. To achieve accurate results, the load cell should be placed on a firm, flat surface that does not come into contact with any objects, with the exception of the lower areas marked in black.

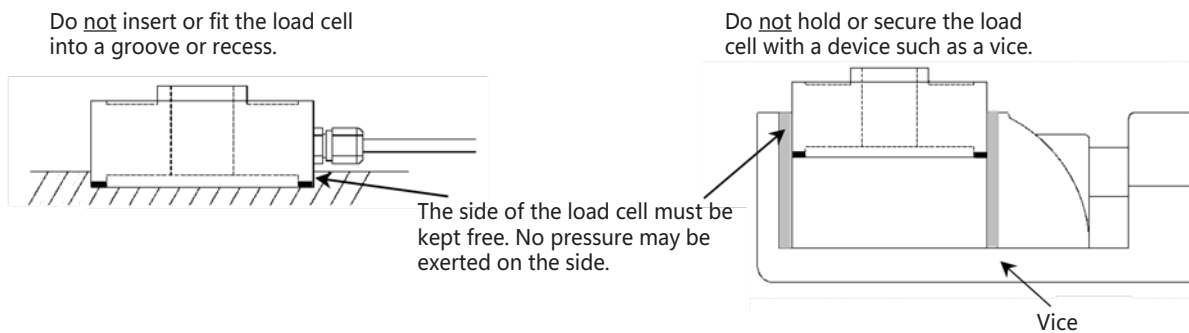

## Specifications

	CHX	eCHX
Accuracy:*	± 2.0 % full scale or less (100 N/500 N) ± 1.0 % full scale or less (2000 N)	± 2.2 % full scale or less (100 N/500 N) ± 1.2 % full scale or less (2000 N)
Rated output:	0.7 - 1.5 mV/V (100 N) 1.2 - 2.0 mV/V (500 N) 1.0 - 1.5 mV/V (2000N)	—
Recommended Voltage: (Allowable Voltage)	5 - 10 V DC (15 V DC)	—
Overload capacity:	150 %	150 %
Recommended temperature: (Allowable temperature)	-10 - 60 °C -20 - 80 °C	-10 - 60 °C -20 - 80 °C
Cable:	Approx. 3 m	Approx. 3 m
Weight:	Approx. 58 g (100 N/500 N) Approx. 82 g (2000 N)	Approx. 58 g (100 N/500 N) Approx. 82 g (2000 N)
Protection rating:**	IP64	IP64

\* It is the accuracy of the load cell and indicator combined.

\*\* Protection rating is only approved for the sensor. The indicator, the connector parts and cable are not secured.