

Flat Chucks GC-1100, GC-1200, GC-5000, GCF-1200

Heavy duty flat grip for various applications



Features

- They are suitable for checking both thin and thick materials.

Applications

- The flat chucks can be installed on the force gauge and test stand for tension test of various test pieces.

Measuring according to standards (only with GCF-1200 with claw GCF-OP-C30)

- ISO 1924-2:1994 - Paper and board - Determination of tensile properties - Part 2: Constant rate of elongation method
- JIS P 8113:2006 - Paper and board - Determination of tensile properties - Part 2: Constant rate of elongation method



Notes

- Particular materials and shapes can not be used. GC-1100, GC-1200 and GC-5000 are not suitable for hard and slippery samples. The standard claws of GCF-1200 can be replaced for such applications.
- Combining with a test stand, more stable measuring becomes possible.
- All information is subject to change without prior notice.

Specifications

	GC-1100	GC-1200	GC-5000	GCF-1200*
Type	standard	wide	high capacity	Multi-purpose
Capacity	1000 N		5000 N	1000 N
Chuck thickness	20 mm		29 mm	20 mm
Chuck depth	20 mm		37.5 mm	20 mm
Mounting screw	M6		M10	M6
Weight	Approx. 160 g	Approx. 170 g	Approx. 1400 g	Approx. 170 g
Mounting Part Angle	Approx. 20°	Approx. 20°	Approx. 17°	Approx. 20°**

The weight of the attachment is also applied as load on the force gauge and had to be considered when selecting the capacity.

*Supplied claws OP-GCF-C10 can be replaced by other claws

**The mounting part can be fixed. This is recommended for use on horizontal test stands or on tables of vertical test stands.

Dimensional drawing

GC-1100/GC-1200

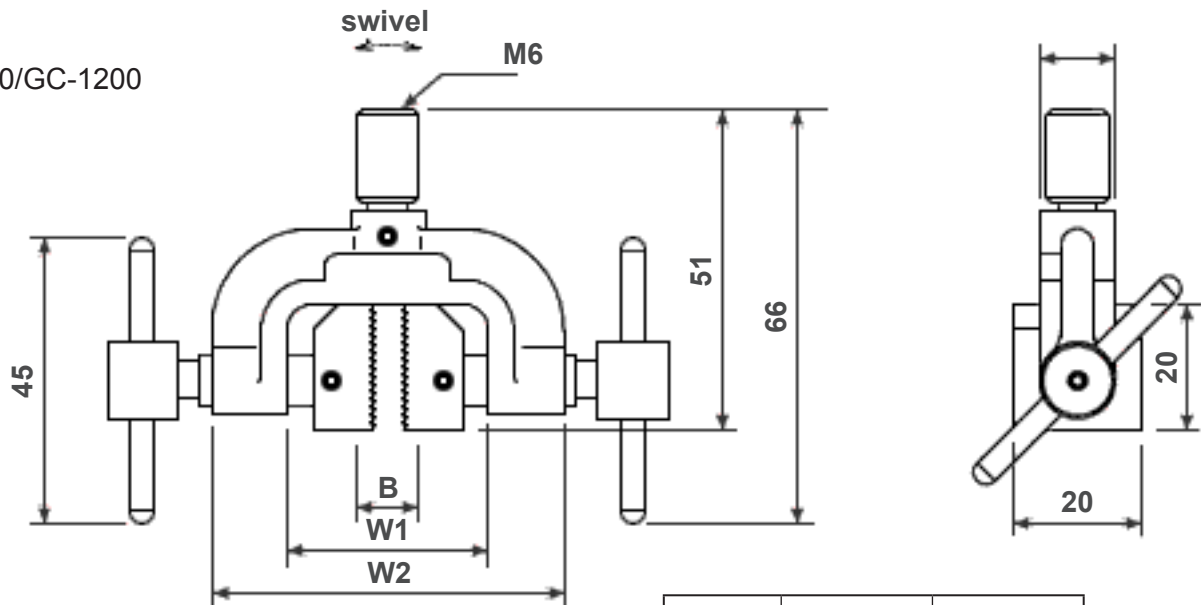

	GC-1100	GC-1200
B	10	20
W1	56	66
W2	98	112

GC-5000

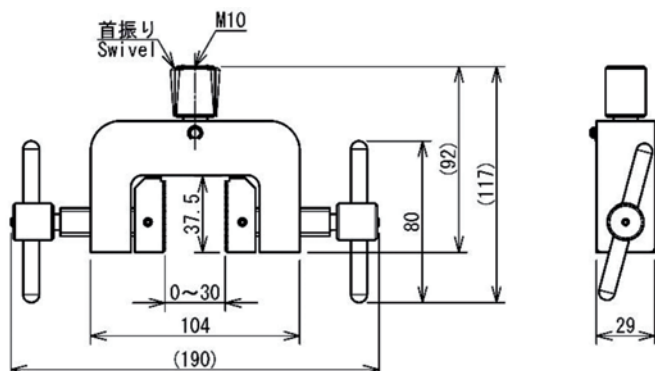

Unit: mm

GCF-1200 and available claws

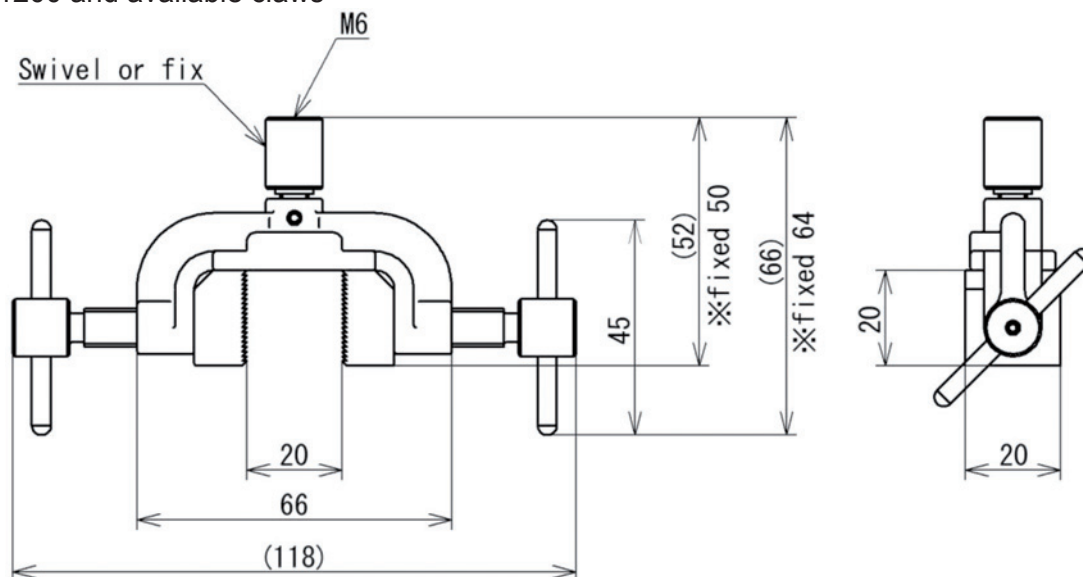

Unit: mm

OP-GCF-C10

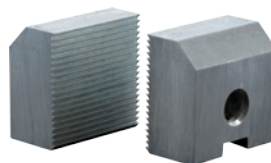
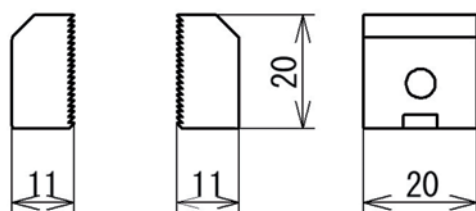

V-Notch claws (supplied)
Capacity 1000 N
Suitable for unsmooth surface samples



Claws are sold as set (2 pcs.)

OP-GCF-C20	OP-GCF-C30	OP-GCF-C40	OP-GCF-C50
<p>Square-Notch claws Capacity 1000 N Suitable for soft and elastic samples such as rubber</p>	<p>Wave-Notch claws Capacity 1000 N Suitable for thin samples such as paper</p>	<p>Parallel claws Capacity 1000 N Suitable for samples with a surface such as aluminium foil</p>	<p>Rubberized claws Capacity 250 N Suitable for gripping samples without damaging them.</p>